

PLAT OF SURVEY

LOT 11, MARINER HILLS, BEING A PART OF THE NORTHWEST 1/4 OF THE SOUTHWEST 1/4, SOUTHWEST 1/4 OF THE SOUTHWEST 1/4, SOUTHEAST 1/4 OF THE SOUTHWEST 1/4, AND THE SOUTHWEST 1/4 OF THE SOUTHEAST 1/4 OF SECTION 34, TOWN 4 NORTH, RANGE 16 EAST, TOWN OF LAGRANGE, WALWORTH COUNTY, WISCONSIN.

SURVEYED FOR: BRAD BEHRANS/ CHOPPER ANDERSON

SURVEY ADDRESS: N7418 MARINER HILLS

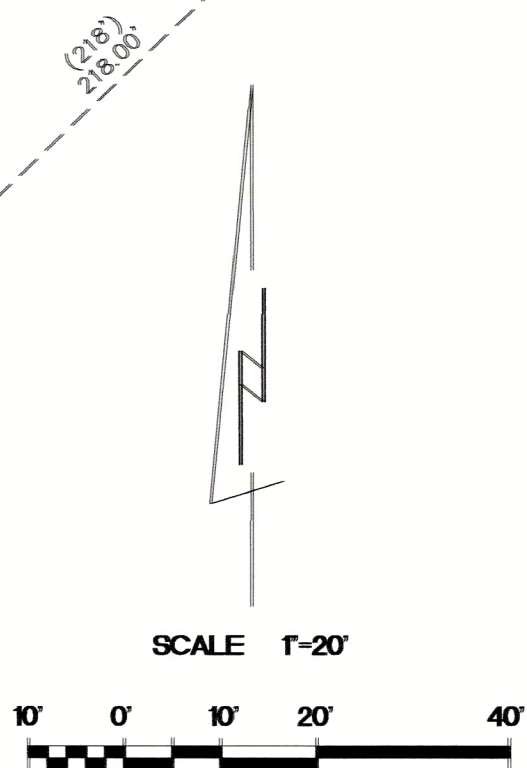

BEARINGS ARE REFERENCED TO THE SOUTH LINE OF THE SOUTHWEST 1/4 OF SECTION 34-4-16 AND IS ASSUMED TO BEAR N87°44'41"E, (NAD83).

21711 SQ. FT.

- FOUND 1 1/4" O.D. IRON PIPE
- FOUND 1 1/4" IRON ROD
- ✱ FOUND 3/4" IRON ROD
- SET 1 1/4" O.D. IRON PIPE
- () RECORDED AS DIMENSIONS

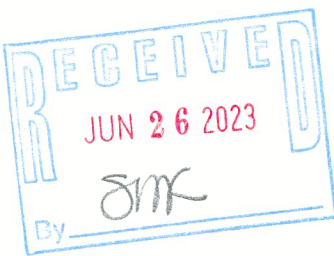

MARINER

HILLS

CIRCLE

MEASURED CURVE DATA

RADIUS	LENGTH	CHORD	BEARING	DELTA
100.00'	314.15'	200.00'	N43°39'57"W	179°59'38"

RECORDED AS CURVE DATA

RADIUS	LENGTH	CHORD	BEARING	DELTA
100'	314.16'	200'	N42°00'W	180°00'

"I hereby certify that I have surveyed the above property and that the above map is a true representation thereof and shows the size and location of the property, its exterior boundaries, the location of all visible structures and dimensions of all principal buildings thereon, boundary fences, apparent easements, roadways and encroachments if any."

"This survey is made for the use of the present owners of the property, and also those who purchase, mortgage or guarantee the title thereto within one year from date hereof."

THIS IS NOT AN ORIGINAL SURVEY UNLESS THE SIGNATURE OF THE SURVEYOR IS PRESENT.

3/16/2023 DATE TEP FIELD WORK BY TEP DRAWN BY 23007 JOB NUMBER

Kettle Moraine Surveying Inc.
P.O. Box 357
Eagle WI 53119
(262)594-3484
kettlemorainesurveying.com



HMH-11

416-3434